

# lagoon<sup>®</sup> Advanced Care

WH6-20LAC and TD6-20LAC

The ideal replacement for any dry-cleaning operation



## Features and benefits



### Keep customers coming back

Outstanding results for garments of every type thanks to specialized detergents and dedicated programs



### Delicate on the delicates

Gentle on fine textiles and wools labelled dry-clean only, as less mechanical action. Woolmark-approved



### Rapid return on investment

With a better loading factor, less prespotting, easier finishing and faster process times



### Sustainable and eco-friendly

Water-based cleaning with none of the disadvantages of PERC, which can be dangerous to staff



### Dry to dry in 1 hour

Smart chemicals and processes mean garments are fully dried in the dryer - no hang-dry

Main specifications				WH6-20LAC
Rated capacity, Laundry	filling factor 1:9	kg / lb		20 / 45
	Wool filling factor 1:15	kg / lb		14 / 31
	Silk filling factor 1:18	kg / lb		10 / 22.5
Drum, volume		litre / ft <sup>3</sup>		180 / 6.4
	diameter	ø mm / inch		725 / 28 9/16
Extraction		rpm		1055
G-factor				450
Heating alternative	electricity	kW		18.0
<b>Consumption data "lagoon"</b>				
Total time	Wool High	min		22
	Wool Medium	min		23
	Silk	min		16
	Synth. mix Medium	min		20
	Synth. mix Low	min		17
	Curtains	min		20
Water consumption (cold+hot)				
	Wool High	litre / gallon		110 / 29
	Wool Medium	litre / gallon		106 / 28
	Silk	litre / gallon		80 / 21
	Synth. mix Medium	litre / gallon		85 / 22
	Synth. mix Low	litre / gallon		80 / 21
	Curtains	litre / gallon		95 / 25
Energy consumption (motor/heating/water)				
	Wool High	kWh		0.15/1.0
	Wool Medium	kWh		0.15/1.0
	Silk	kWh		0.05/0.6
	Synth. mix Medium	kWh		0.15/1.0
	Synth. mix Low	kWh		0.05/0.95
	Curtains	kWh		0.05/0.7
<b>Consumption data ECO 60 1:9*</b>				
Total time		min		65
Water consumption (cold+hot)		litre / gallon		113+10 / 30+3
Energy consumption (motor/heating/hot water)		kWh		0.5/2.2/0.55
Residual moisture		%		45

\* Water temperature 15°C cold water and 65°C hot water.

Main specifications				TD6-20LAC			
Rated capacity, Drying	filling factor 1:18	kg / lb		20 / 44.1			
Drum, volume		litre / gallon		360 / 12.7			
	diameter	ø mm / inch		755 / 29 3/4			
Heating alternative	electricity	kW		18.0			
	gas	BTU/h (kW)		21.0			
	steam at 700 kPa			25.0			
	heat pump	kW		6.5			
<b>Consumption data "lagoon"</b>				El	Gas	Steam	Heat pump
Total time	Wool High*	min		26	25	22	31
	Wool Medium*	min		23	22	20	28
	Synthetic mix**	min		31	30	27	29
<b>Consumption data***</b>							
Total time		min		27	26	23	44
Energy consumption (motor/heating/hot water)		kWh		8.2	9.3	9.6	2.99
Evaporation		g/min / oz/min		302 / 10.7	321 / 11.3	352 / 12.4	185 / 6.5
Energy/Water evaporation		kWh/l / BTU/gallon		1.00 / 12916	1.13 / 14596	1.17 / 15112	0.36 / 4650

\* 1:30 load 100% wool load at 30% initial moisture dried to 0%.

\*\* 1:40 load 100% synthetic load at 20% initial moisture dried to 0%.

\*\*\* At rated capacity 100% cotton load at 50% initial moisture dried to 0%.

Electrical connections					
Heating alternative	Main voltage		Heating power kW	Total power kW	Recommended fuse ITCB A
		Hz			
Electric heated	208-240V 3-	60	18.0	18.5	60
	440V 3-	60	18.0	18.5	30
	480V 3-	60	18.0	18.5	30
Steam or Non heated	208-240V 1-	60	*	2.5	15
	440/480V 1/3-	60	*	2.6	15

\* Total power and recommended fuse does not depend on the heating power in those cases.

Water and steam connection		WH6-20LAC
Water valves	DN / inch	20 / 3/4
Water pressure	kPa / psi	200-600 / 30-90
Capacity at 300 kPa	l/min / gallon/min	30 / 8
Drain valve	∅ mm / inch	75 / 3
Draining capacity	l/min / gallon/min	170 / 45
Steam valve	DN / inch	15 / 1/2
Steam pressure	kPa / psi	300-600 / 7-40
Liquid detergent supplies		5
Floor requirements		
Frequency of the dynamic force	Hz	17.6
Floor load at max extraction	kN	4.2 ± 1.0
Sound levels		
Sound power/pressure level at extraction*	dB(A)	84/68
Sound power/pressure level at wash*	dB(A)	66/50
Heat emission		
% of installed power, max		5
Shipping data**		
Weight	net, kg/lbs	354 / 780
Shipping volume	m <sup>3</sup> / ft <sup>3</sup>	1.66 / 59
Accessories		
Steel base		x
Hose kits for water or steam		x
Fluff collector		x
Dimensions in mm / inch		
A	Width	970 / 38 3/16
B	Depth	945 / 37 3/16
C	Height	1410 / 55 1/2
D1		460 / 18 1/8
D2		525 / 20 11/16
E		1510 / 59 7/16
F		1130 / 44 1/2
G		150 / 5 7/8
H		1330 / 52 3/8
I		400 / 15 3/4
J		300 / 11 13/16
K		1290 / 50 13/16
L		1210 / 47 5/8
M		350 / 13 3/4
N		100 / 3 15/16
O		335 / 13 3/16
P		340 / 13 3/8
Q		215 / 8 7/16
1	Display	7 Cold/Hot water or
2	Door opening ∅ 435 mm / 17 1/8 inch	8 Re-used water with network pressure (option)
3	Detergent box	9 Re-used water from tank/pump or
4	Cold/Hot water (Detergent box)	10 Liquid detergent supply
5	Cold water	11 Drain
6	Hot water	12 Electrical connection
		12 Steam connection

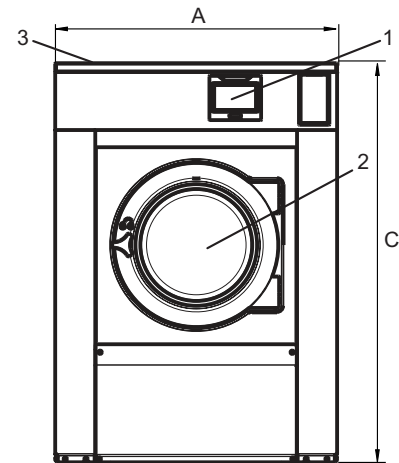

Front

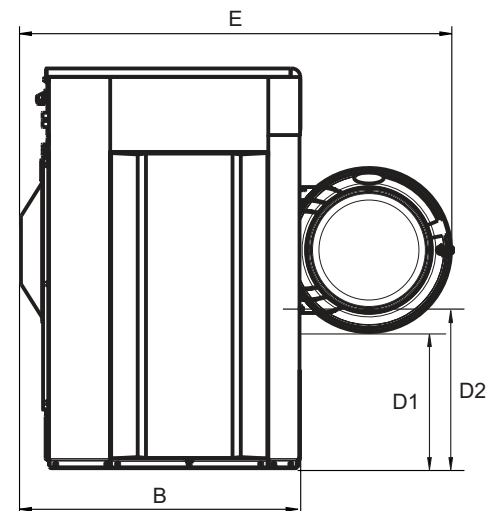

Side view

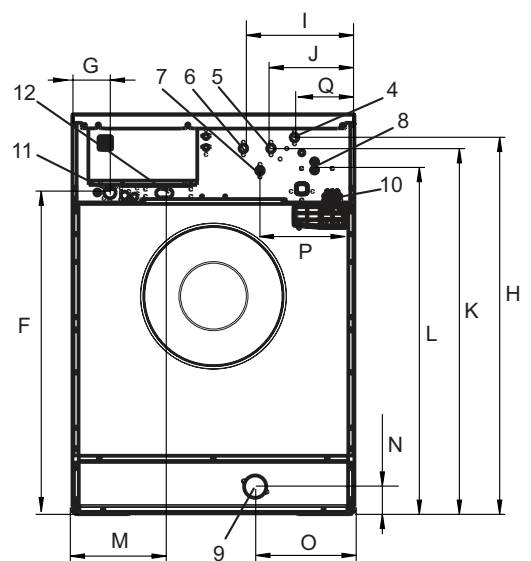

Rear

\* Sound power levels measured according to ISO 60704.

\*\* Average data. Crated weight/shipping volume depends on configuration. Please contact logistics for exact measures.

Electrical connections					
Heating alternative	Main voltage		Heating power kW	Total power kW	Recommended fuse ITCB A
		Hz			
Electric heated	208-240V 3-	60	18.0	19.0	60
	440V 3 -	60	18.0	19.0	35
	480V 3 -	60	18.0	19.0	30
Gas heated/ Steam heated	120-480V 1/3-	60	*	1.0	15

\* Total power and recommended fuse does not depend on the heating power in those cases.

Steam, gas and air connections			TD6-20LAC
Steam		ISO 7/1-R	1"
Steam pressure		kPa / psi	100-1000 / 14.5-145
Steam consumption		kg/h / lb/h	35 / 77.2
Condensate		ISO 7/1-R	1"
Gas		ISO 7/1-R	1/2"
Gas pressure	Natural gas	Pa / psi	2000 / 0.29
		mbar	20
	Propane	Pa / psi	2800-5000 / 0.41-0.73
		mbar	28-50
Air outlet		∅ mm / inch	200 / 7 7/8
Evacuated air,	el 18.0 kW	m <sup>3</sup> /h / ft <sup>3</sup> /h	525 / 18540
	gas 21.0 kW		600 / 21189
	steam 25.0 kW		690 / 24367
Pressure drop	el 18.0 kW	Max. Pa / psi	650 / 0.094
	gas 21.0 kW		650 / 0.094
	steam 25.0 kW		650 / 0.094
Sound levels			
Sound power/pressure level at drying*			
		dB(A)	72/56
Heat emission			
% of installed power, max			15
Shipping data**			
Weight	net, kg / lbs		243 / 536
Shipping volume	crated, m <sup>3</sup> / ft <sup>3</sup>		2.15 / 76
Dimensions in mm / inch			
A	Width		790 / 31 1/8
B(a)	Depth, el and gas		1200 / 47 1/4
B(b)	Depth, steam		1340 / 52 3/4
C	Height		1770 / 69 11/16
D			775 / 30 1/2
E			835 / 32 7/8
F			750 / 29 1/2
G			110 / 4 5/16
H			60 / 2 3/8
I			270 / 10 5/8
J			240 / 9 7/16
K			175 / 6 7/8
L			605 / 23 13/16
M			740 / 29 1/8
N			395 / 15 9/16
1	Operating panel		
2	Door opening ∅ 580 mm / 22 13/16 inch		
3	Electrical connection on gas heated machines		
4	Gas connection/Electrical connection on electrical heated machines		
5	Exhaust connection		
6	Condensate connection		
7	Steam connection		

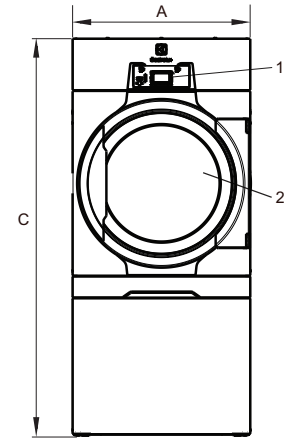

Front

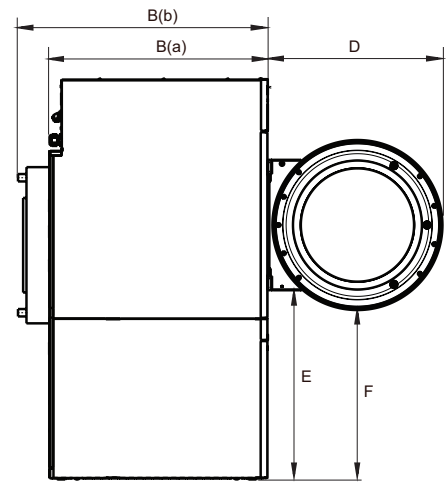

Left side

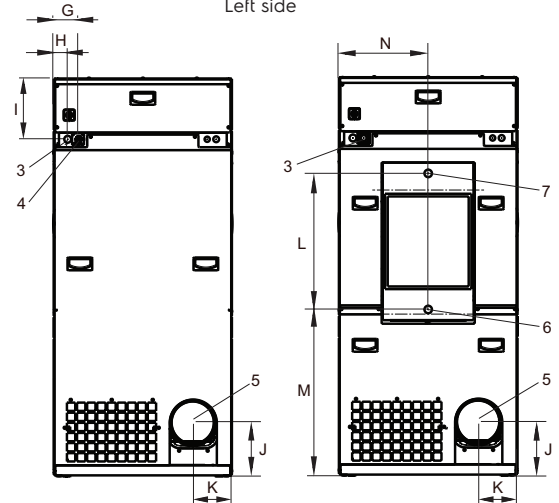

El, gas

Steam

Rear side

Front and side panels in silver grey and dark blue (color samples can be ordered on part number 472998313).

\* Sound power levels measured according to ISO 60704.

\*\* Average data. Crated weight/shipping volume depends on configuration. Please contact logistics for exact measures.

Electrical connections					
Heating alternative	Main voltage		Heating power kW	Total power kW	Recommended fuse ITCB A
	Hz				
Heat pump	208-240V 1-	60	*	5.5	30
	440/480V 3-	60	*	6.2	15

\* Total power and recommended fuse does not depend on the heating power in those cases.

Sound levels	TD6-20LAC	
Sound power/pressure level at drying*	dB(A)	
	72/56	
Heat emission		
% of installed power, max	15	
Shipping data**		
Weight	net, kg / lbs	308 / 679
Shipping volume	crated, m <sup>3</sup> / ft <sup>3</sup>	2.15 / 76
Dimensions in mm / inch		
A(a) Width	790 / 31 1/8	
B(a) Depth	1200 / 47 1/4	
B(b) Depth	1230 / 48 7/16	
C Height	1770 / 69 11/16	
D	775 / 30 1/2	
E	835 / 32 7/8	
F	750 / 29 1/2	
G	110 / 4 5/16	
H	270 / 10 5/8	
I	125 / 4 15/16	
J	260 / 10 1/4	
1	Operating panel	
2	Door opening $\varnothing$ 580 mm / 22 13/16 inch	
3	Electrical connection	
4	Drain for condense water	

Front and side panels in silver grey and dark blue (color samples can be ordered on part number 472998313).

\* Sound power levels measured according to ISO 60704.

\*\* Average data. Crated weight/shipping volume depends on configuration. Please contact logistics for exact measures.

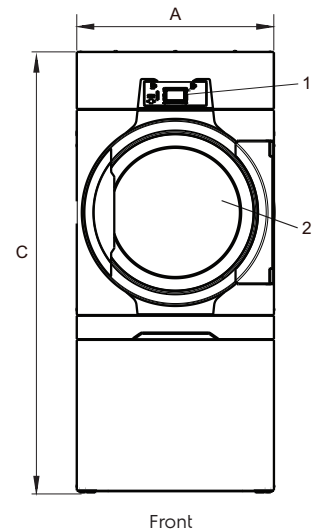

Front

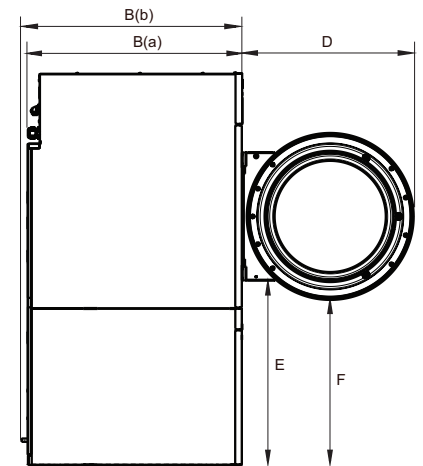

Left side

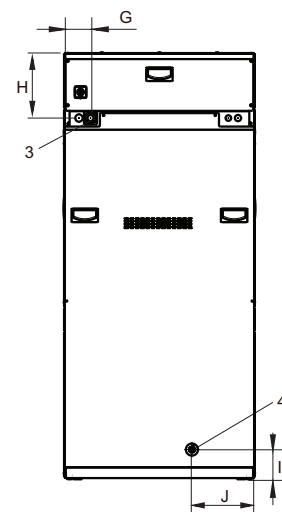

Rear side



Jetsave PNCs	Description
988930001	Complete kit with 2 pumps, 550 ml/min
988930002	Complete kit with 3 pumps, 550 ml/min
988930003	Complete kit with 4 pumps, 550 ml/min
988930004	Complete kit with 5 pumps, 550 ml/min

Accessories PNCs	Description
988916611	Single low level probe
432930071	Extension POWER cable (6m)
432930072	Extension DATA cable (6m)
988930031	ID interface for 3rd part party peristaltic pumps or option for Low level alarm
432930065	Joining kit

Power supply
From the washer extractor: 100-240V- 50/60 Hz / 0.1A (Max)

Water supply
Min. 1.8 bar
Max. 6 bar

Electrolux Professional name and description	Packaging 20 litres	Packaging 10 litres
W01 - lagoon Sensitive Detergent Professional detergent for natural/animal fiber	432731085	432731086
W03 - lagoon Sensitive Conditioner Professional conditioner for natural/animal fiber	432731087	432731088
W02 - lagoon Delicate Detergent Professional delicate universal detergent	432731089	432731090

For further information including spotting agents, please refer to the lagoon detergent Product Data Sheet



**BASE; closed front and sides**

Suitable for models: WH6-20LAC  
988918871  
Height: 230 mm / 9 1/16 inch  
Material: Galvanised, silver grey painted steel  
with stainless steel front panel.

**BASE; "floating foundation"**

Suitable for models: WH6-20LAC  
988918872  
Material: Galvanised, silver grey painted steel with  
stainless steel front panel.  
Feature: A "floating foundation" filled with  
concrete eliminates noise to other parts  
of the building.

